

Elevation

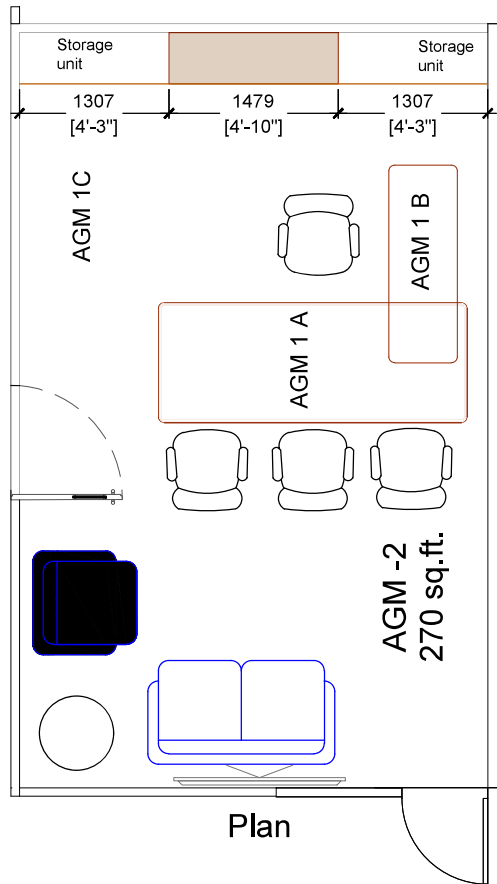

Plan

NOTES:

1. THIS DRAWING IS ISSUED FOR VALIDATION ONLY AND SHOULD BE USED ONLY FOR THE PURPOSE IT IS ISSUED FOR.
2. ALL DIMENSIONS ARE FROM FINISHED TO FINISHED SURFACES.
3. DO NOT SCALE THIS DRAWING.
4. ALL DIMENSIONS ARE IN MM.

MITIMITRA CONSULTANTS PVT.LTD. HOLDS THE COPYRIGHT OF THIS DESIGN AS PER THE INDIAN COPY RIGHT ACT, 1957 CLAUSE NO 17 & 18 IN THE CAPACITY OF THE AUTHOR, THIS DRAWING SHOULD NOT BE COPIED, REPRODUCED OR USED WITHOUT THE EXPRESS PERMISSION OF MCPL.

ISSUED ON	ISSUED TO	ISSUED FOR	COPIES
	JOB NO: <b>SBI06</b>	DRAWING NO: <b>10R1/TD/01</b>	DATE: <b>14/11/2024</b>
	DRAWN BY: <b>PK</b>	CHECKED BY: <b>RJ</b>	SCALE: <b>1:25</b>

PROJECT:  
**PROPOSED INTERIOR DESIGN SCHEME OF NEW SBI LOCAL HEAD OFFICE AT KHARADI, PUNE.**

MITIMITRA CONSULTANTS  
ARCHITECTS, INTERIORS & LANDSCAPE DESIGNERS & GOVT. APPRD. VALUERS  
1st Floor, 'ARTHABODHI', 96/8/21-22, Senapati Bapat Road, Pune-411 016.  
TEL - 25650218, 65220218 FAX - 25651228 E-MAIL - mitimitra@gmail.com

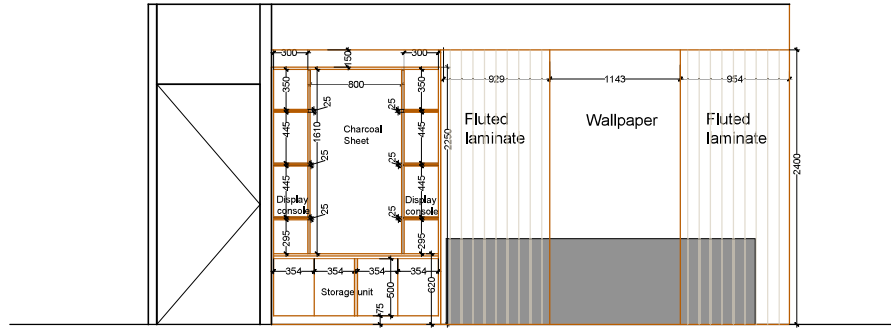

Elevation

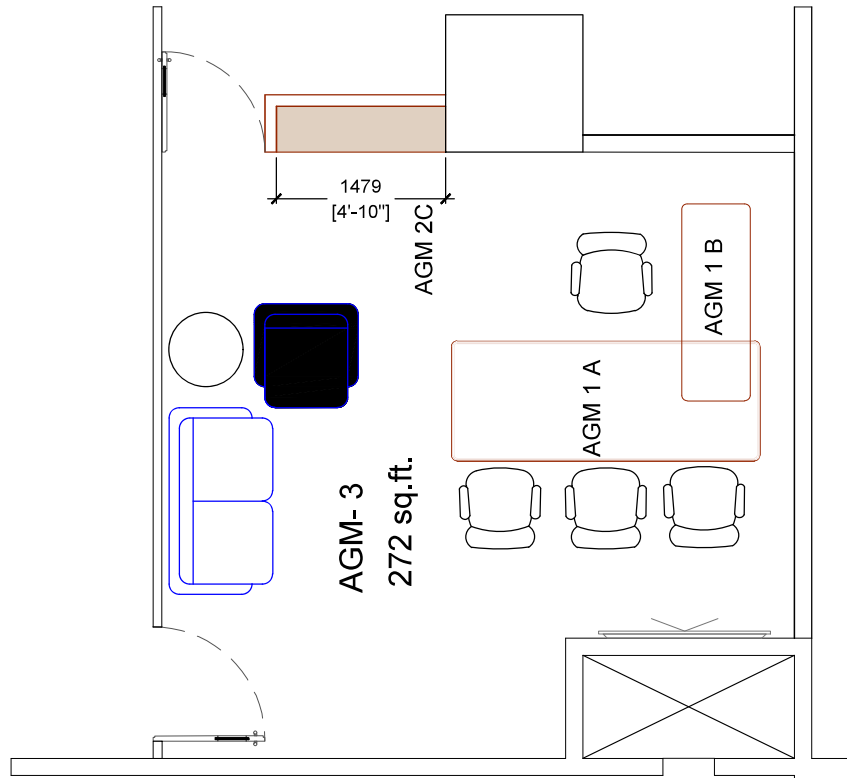

Plan

NOTES:

1. THIS DRAWING IS ISSUED FOR VALIDATION ONLY AND SHOULD BE USED ONLY FOR THE PURPOSE IT IS ISSUED FOR.
2. ALL DIMENSIONS ARE FROM FINISHED TO FINISHED SURFACES.
3. DO NOT SCALE THIS DRAWING.
4. ALL DIMENSIONS ARE IN MM.

MITIMITRA CONSULTANTS PVT.LTD. HOLDS THE COPYRIGHT OF THIS DESIGN AS PER THE INDIAN COPY RIGHT ACT, 1957 CLAUSE NO 17 & 18 IN THE CAPACITY OF THE AUTHOR, THIS DRAWING SHOULD NOT BE COPIED, REPRODUCED OR USED WITHOUT THE EXPRESS PERMISSION OF MCPL.

ISSUED ON	ISSUED TO	ISSUED FOR	COPIES
	JOB NO: <b>SBI06</b>	DRAWING NO: <b>11R1/TD/02</b>	DATE: <b>14/11/2024</b>
	DRAWN BY: <b>PK</b>	CHECKED BY: <b>RJ</b>	SCALE: <b>1:25</b>

PROJECT:  
**PROPOSED INTERIOR DESIGN SCHEME OF NEW SBI LOCAL HEAD OFFICE AT KHARADI, PUNE.**

**MITIMITRA CONSULTANTS**  
 ARCHITECTS, INTERIORS & LANDSCAPE DESIGNERS & GOVT. APPRD. VALUERS  
 1st Floor, 'ARTHA80DH', 96&7/21-22, Senapati Bapat Road, Pune - 411 016  
 TEL - 25650218, 65220218 FAX - 25651228 E-MAIL - mitimitra@gmail.com

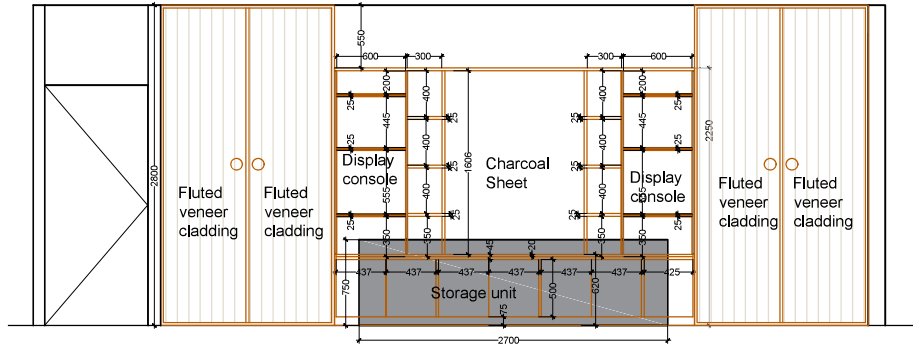

Elevation

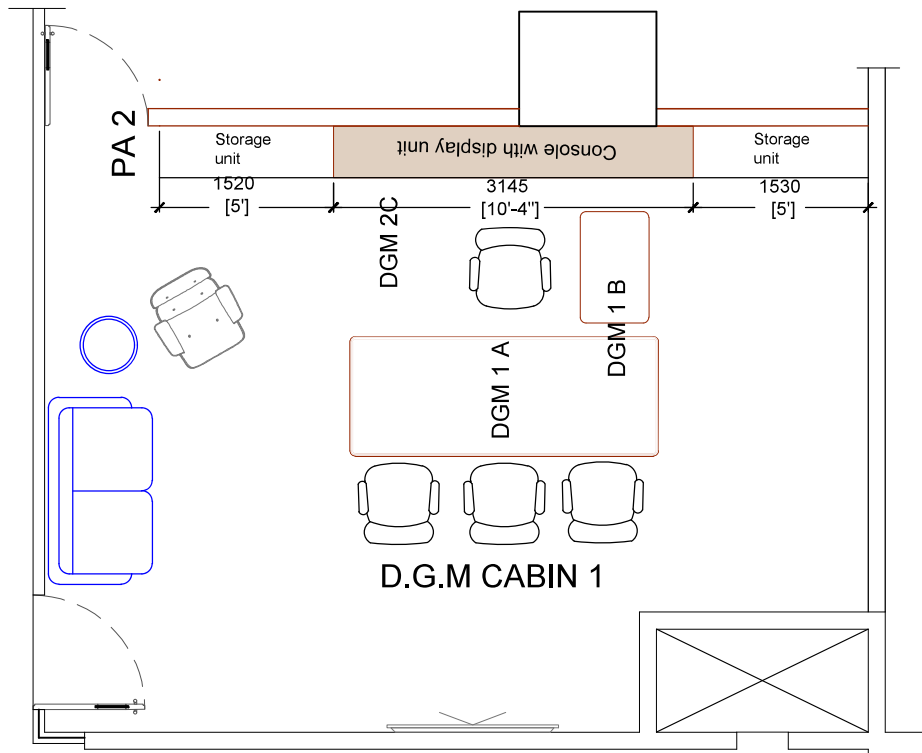

Plan

NOTES:

1. THIS DRAWING IS ISSUED FOR VALIDATION ONLY AND SHOULD BE USED ONLY FOR THE PURPOSE IT IS ISSUED FOR.
2. ALL DIMENSIONS ARE FROM FINISHED TO FINISHED SURFACES.
3. DO NOT SCALE THIS DRAWING.
4. ALL DIMENSIONS ARE IN MM.

MITIMITRA CONSULTANTS PVT.LTD. HOLDS THE COPYRIGHT OF THIS DESIGN AS PER THE INDIAN COPY RIGHT ACT, 1957 CLAUSE NO 17 & 18 IN THE CAPACITY OF THE AUTHOR, THIS DRAWING SHOULD NOT BE COPIED, REPRODUCED OR USED WITHOUT THE EXPRESS PERMISSION OF MCPL.

ISSUED ON	ISSUED TO	ISSUED FOR	COPIES
	JOB NO:	DRAWING NO:	DATE:
	SBI06	13R1/TPIn04	14/11/2024
	DRAWN BY:	CHECKED BY:	SCALE:
	PK	RJ	1:25

PROJECT:  
**PROPOSED INTERIOR DESIGN SCHEME OF NEW SBI LOCAL HEAD OFFICE AT KHARADI, PUNE.**

MITIMITRA CONSULTANTS  
ARCHITECTS, INTERIOR & LANDSCAPE DESIGNERS & GOVT. APPRD. VALUERS  
1st Floor, 'ARTHABODHI', 96/8/21-22, Senapati Bapat Road, Pune - 411 016,  
TEL - 25650218, 65220218 FAX - 25651228 E-MAIL - mitimitra@gmail.com

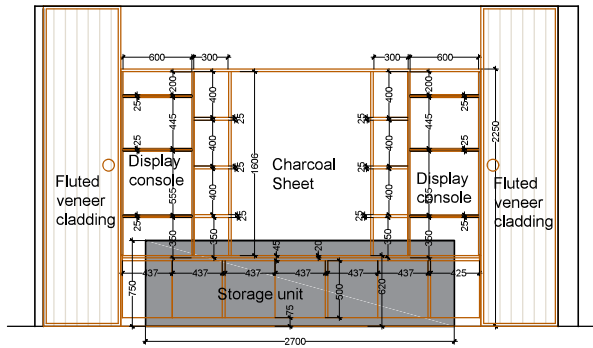

Elevation

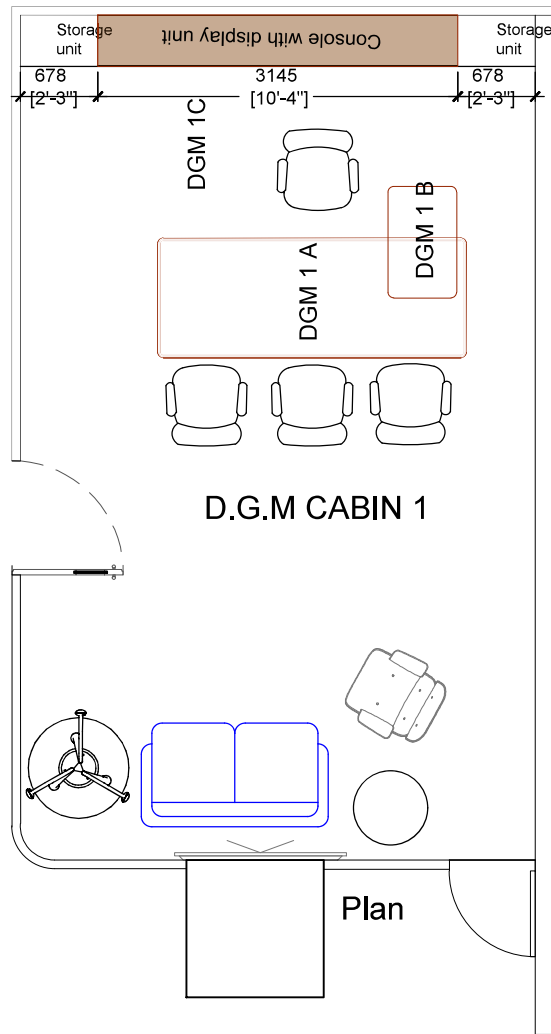

NOTES:

1. THIS DRAWING IS ISSUED FOR VALIDATION ONLY AND SHOULD BE USED ONLY FOR THE PURPOSE IT IS ISSUED FOR.
2. ALL DIMENSIONS ARE FROM FINISHED TO FINISHED SURFACES.
3. DO NOT SCALE THIS DRAWING.
4. ALL DIMENSIONS ARE IN MM.

MITIMITRA CONSULTANTS PVT.LTD. HOLDS THE COPYRIGHT OF THIS DESIGN AS PER THE INDIAN COPY RIGHT ACT, 1957 CLAUSE NO 17 & 18 IN THE CAPACITY OF THE AUTHOR, THIS DRAWING SHOULD NOT BE COPIED, REPRODUCED OR USED WITHOUT THE EXPRESS PERMISSION OF MCPL.

ISSUED ON	ISSUED TO	ISSUED FOR	COPIES
	JOB NO:	DRAWING NO:	DATE:
	SBI06	12R1/TPIn03	14/11/2024
	DRAWN BY:	CHECKED BY:	SCALE:
	PK	RJ	1:25

PROJECT:  
**PROPOSED INTERIOR DESIGN SCHEME OF NEW SBI LOCAL HEAD OFFICE AT KHARADI, PUNE.**

**MITIMITRA CONSULTANTS**  
ARCHITECTS, INTERIORS & LANDSCAPE DESIGNERS & GOVT. APPROD. VALUERS  
1st Floor, 'ARTHABODHI', 96/8/21-22, Senapati Bapat Road, Pune-411 016,  
TEL - 25650218, 65220218 FAX - 25651228 E-MAIL - mitimitra@gmail.com

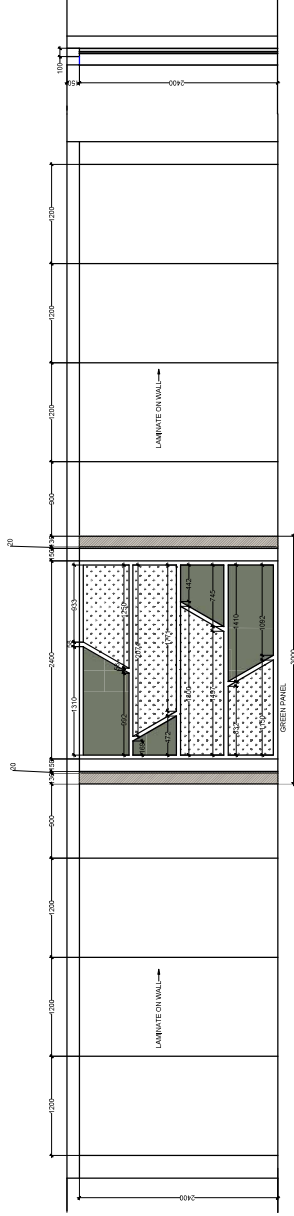

SECTIONAL ELEVATION

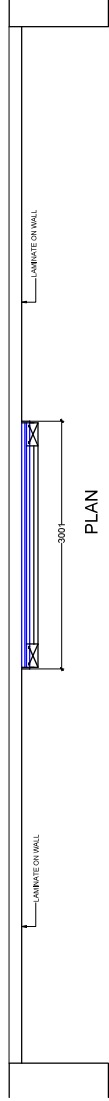

PLAN

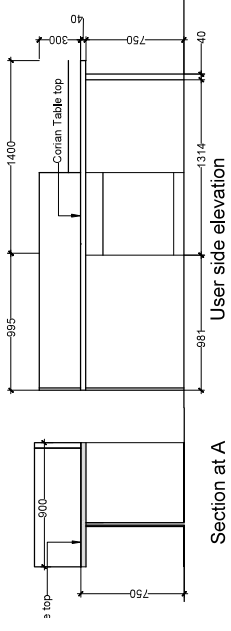

User side elevation

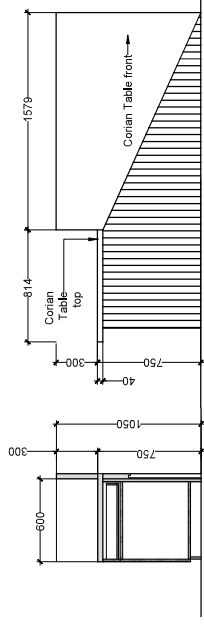

front elevation

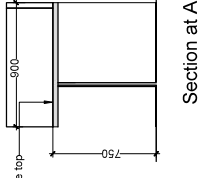

Section at A

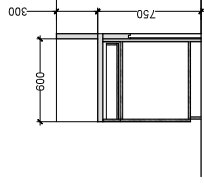

Section at B

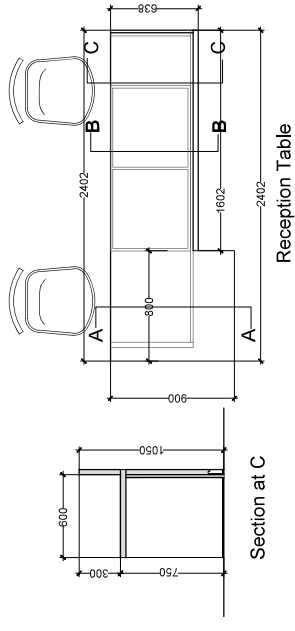

Reception Table

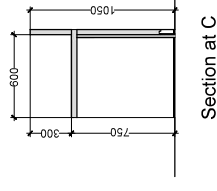

Section at C

NOTES:

1. THIS DRAWING IS ISSUED FOR VALIDATION ONLY AND SHOULD BE USED ONLY FOR THE PURPOSE IT IS ISSUED FOR.
2. ALL DIMENSIONS ARE FROM FINISHED TO FINISHED SURFACES.
3. DO NOT SCALE THIS DRAWING.
4. ALL DIMENSIONS ARE IN MM.

MITIMITRA CONSULTANTS PVT.LTD. HOLDS THE COPYRIGHT OF THIS DESIGN AS PER THE INDIAN COPY RIGHT ACT, 1957 CLAUSE NO 17 & 18 IN THE CAPACITY OF THE AUTHOR. THIS DRAWING SHOULD NOT BE COPIED, REPRODUCED OR USED WITHOUT THE EXPRESS PERMISSION OF MCPL.

ISSUED ON	ISSUED TO	ISSUED FOR	COPIES
JOB NO: <b>SB106</b>	DRAWING NO: <b>15R1/TDR106</b>	DATE: <b>14/11/2024</b>	
	DRAWN BY: <b>PK</b>	CHECKED BY: <b>RJ</b>	SCALE: <b>1:30</b>

PROJECT:  
**PROPOSED INTERIOR DESIGN SCHEME OF NEW SBI LOCAL HEAD OFFICE AT KHARADI, PUNE.**

**MITIMITRA CONSULTANTS**  
 ARCHITECTS, INT & LANDSCAPE DESIGNERS & GOVT.APPRD. VALUERS  
 1st Floor, 'ARITHABODH' -968/21-22, Senapati Bapat Road Pune-411 016  
 TEL - 25650218, 65220218 FAX - 25451228 E-MAIL- mitimitra@gmail.com

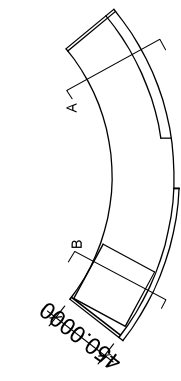
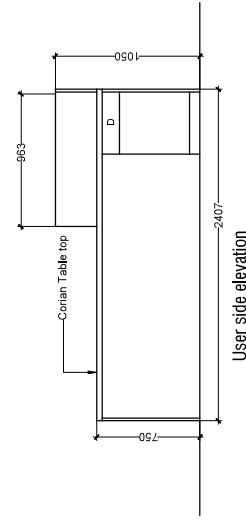
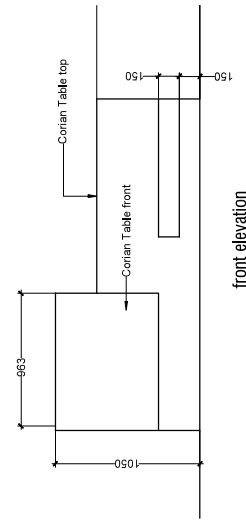
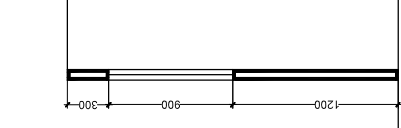
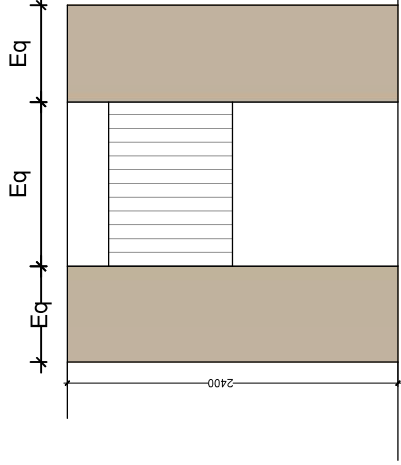

front elevation

sectional elevation

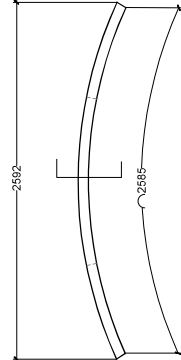
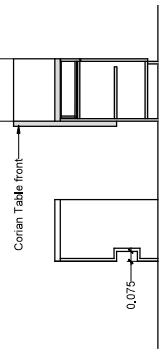

Reception Table

Section A

Section B

NOTES:

1. THIS DRAWING IS ISSUED FOR VALIDATION ONLY AND SHOULD BE USED ONLY FOR THE PURPOSE IT IS ISSUED FOR.
2. ALL DIMENSIONS ARE FROM FINISHED TO FINISHED SURFACES.
3. DO NOT SCALE THIS DRAWING.
4. ALL DIMENSIONS ARE IN MM.

MITIMITRA CONSULTANTS PVT.LTD. HOLDS THE COPYRIGHT OF THIS DESIGN AS PER THE INDIAN COPY RIGHT ACT, 1957 CLAUSE NO 17 & 18 IN THE CAPACITY OF THE AUTHOR. THIS DRAWING SHOULD NOT BE COPIED, REPRODUCED OR USED WITHOUT THE EXPRESS PERMISSION OF MCPL.

ISSUED ON	ISSUED TO	ISSUED FOR	COPIES
	JOB NO :	DRAWING NO :	DATE :
	SBI06	14R1/2024	14/11/2024
	DRAWN BY :	CHECKED BY :	SCALE :
	PK	RJ	1:30

PROJECT :  
**PROPOSED INTERIOR DESIGN SCHEME OF NEW SBI LOCAL HEAD OFFICE AT KHARADI, PUNE.**

**MITIMITRA CONSULTANTS**  
 ARCHITECTS, INT & LANDSCAPE DESIGNERS & GOVT. APPRD. VALUERS  
 1st Floor, "AR THABODH" -968/21-72, Senapati Bapat Road Pune-411 016  
 TEL - 25650218, 65220218 FAX - 25651228 E-MAIL- mitimitra@gmail.com